

TSU1000M Remote Sensor Setup Instructions

TankScan | Powered by AquaPhoenix

Connect Battery Pack and Test Connection

- 1 For tank farm systems with a gateway, set up gateway before connecting battery pack.

Select a spot near tank you are installing.

To power up TankScan Monitor unscrew enclosure cover. Connect battery pack cable to connector on circuit board as shown.

Reinstall cover and hand tighten firmly.

Monitor will wake up and sound 1 beep. Then a second single beep will follow, with a third single beep for data transmission. 3 single beeps indicates a good connection was made.

If more than 3 single beeps were heard, please contact technical support at 877-847-7226 or tankscansupport@aquaphoenixsci.com.

If 3 single beeps are confirmed, then proceed as follows.



Caution. Use only the provided battery pack part # TSTRB01000.



1

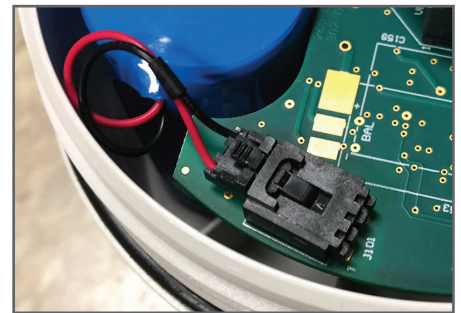

3

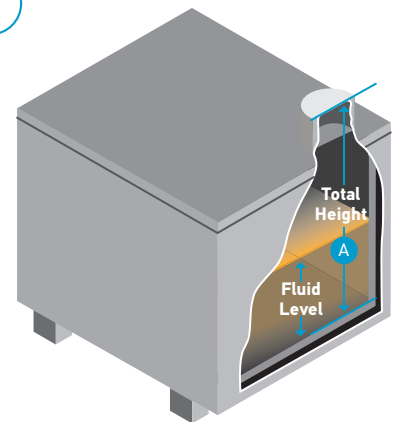

Take Measurements

- 2 Remove any equipment from tank port to be used by sensor if present.
- 3 Measure tank height from inside bottom of tank to top of tank port and to top of fluid level in tank. Record these measurements and report them to CCT.

NOTE: If your monitor came with a stilling tube, install that now, follow included instructions.

Tank Height: _____

Fluid Level: _____

TSU1000M Remote Sensor Setup Instructions

TankScan | Powered by AquaPhoenix

Mount the TSU Monitor

- 4** If tank is metal, attach mounting base onto tank and push down until all four feet are touching. Tighten wing nuts until mounting base no longer wobbles. This allows mounting base to adapt to different tank shapes.

If tank is plastic or non-magnetic, clean area on tank mounting base will attach to. Remove backing from VHB tape feet and attach mounting base onto tank. Press down firmly on base for a few seconds to ensure good adhesion.

- 5** Screw TSU monitor into mounting base.

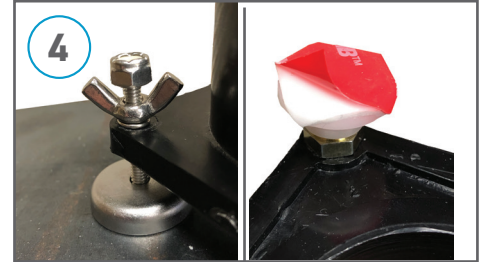

Startup TSU Monitor

- 6** Screw sensor into tank port or stilling tube until tight.
- Seal pipe threads of sensor using product appropriate for this application prior to tightening into tank port.
- 7** Connect 90° female end of sensor cable into connector on top of sensor and finger tighten only.
- 8** Connect straight male end of sensor cable into connector on TSU monitor and finger tighten only.
- 9** Locate triangle indicator on outside of TSU monitor. Using magnetic end of screwdriver, swipe along rim above indicator until a beep is heard.
- 10** Use included zip ties to secure sensor cable and prevent cable from hanging and reduce slack.
- 11** Call TankScan Technical Support after swiping monitor to complete monitor setup.

Note: Step 11 must be completed for the unit to function.

**TankScan
Technical Support**

**877-847-7226
CCT@TankScan.com**

223-0176-001 Rev. B 7/23/2025

AquaPhoenix Scientific
860 Gitts Run Road
Hanover, PA 17331

PH: 877-847-7226

www.tankscan.com



AquaPhoenix[®]
SCIENTIFIC

©2025 AquaPhoenix. All Rights Reserved. TankScan images and marketing materials are protected by various patents, copyrights and/or trademarks. AquaPhoenix assumes no responsibility for any errors which may appear in this document, reserves the right to change devices or specifications detailed herein at any time without notice, and does not make any commitment to update the information contained herein. No licenses to patents or other intellectual property of AquaPhoenix are granted by the Company in connection with the sale of TankScan products, expressly or by implication.